

TECHNICAL INFORMATION DL 57

STANDARD INSTALLATION SITUATIONS

Installation in wood, HPL, glass or steel is possible with the same components. The milling groove and stamping configuration is identical for Freecode and Fixcode.

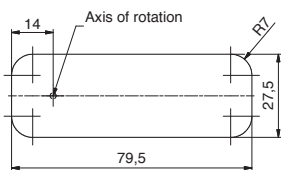
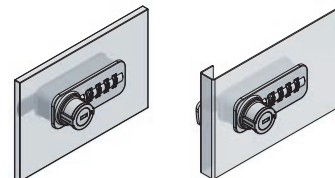
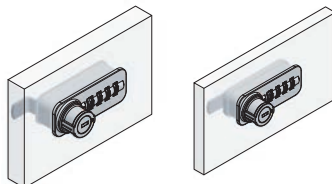

Milling groove, wood / HPL
16–21 mm

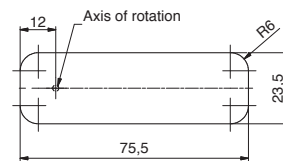

Stamping configuration, glass / steel
0,8–3 mm

ROTATION DIRECTION

 Bolt and knob 180° rotary

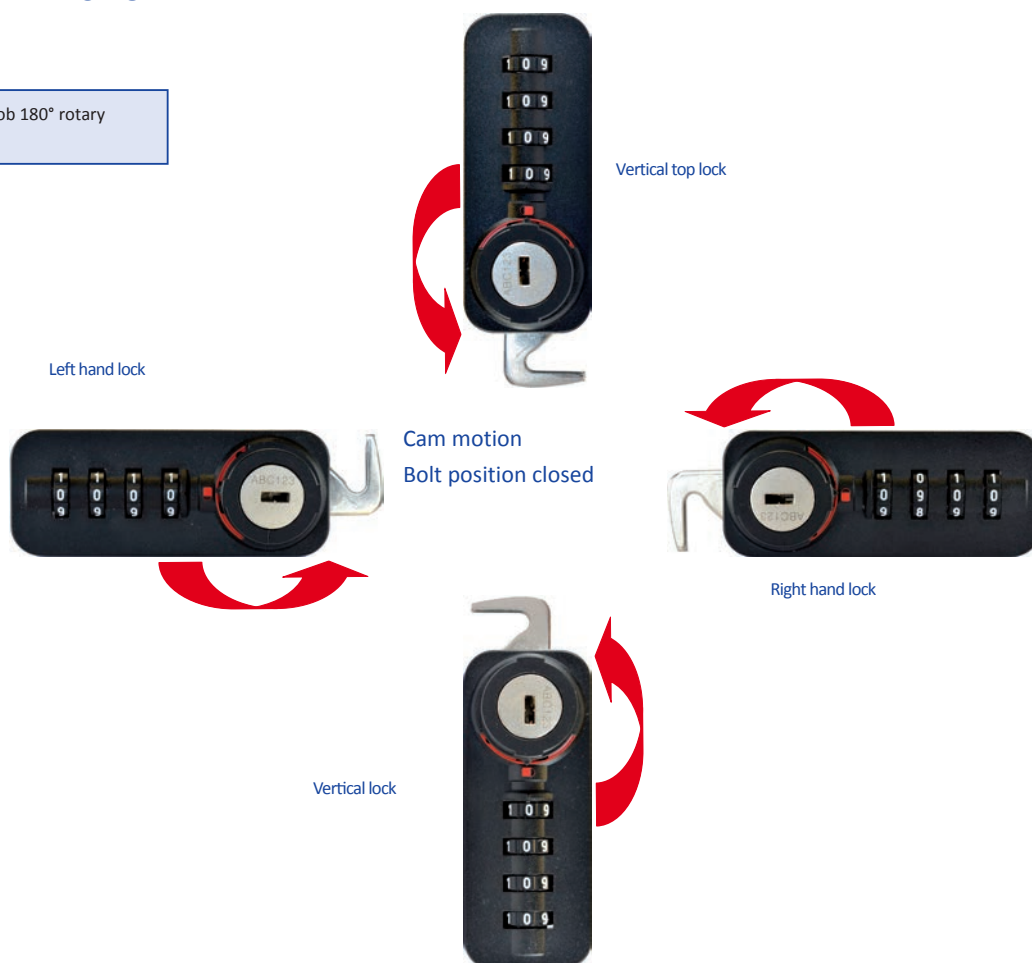

Dial Lock 57

Dial Lock 57.01 Fixcode

Cam lock

Tambour locks

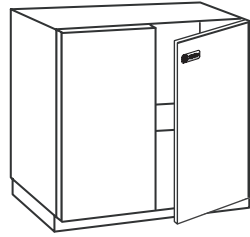
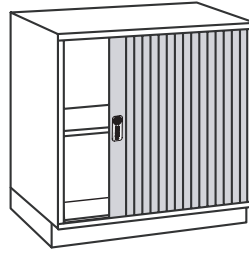

Dial Lock 57.01 Fix

Lock for Cam

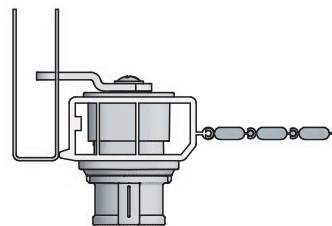
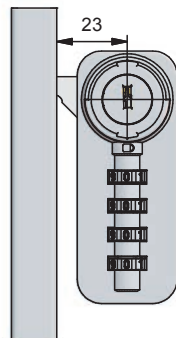
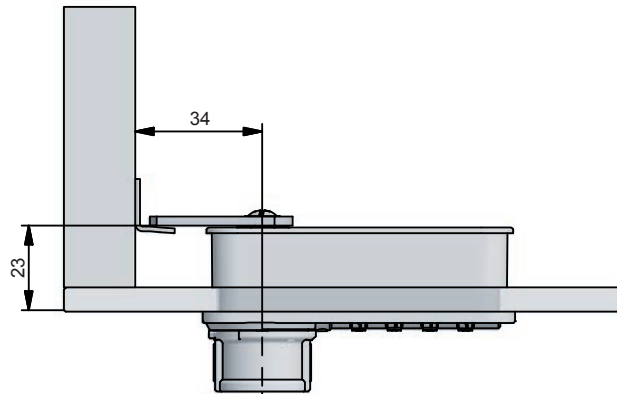
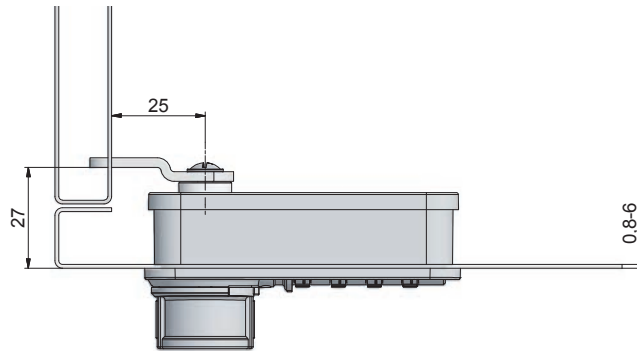
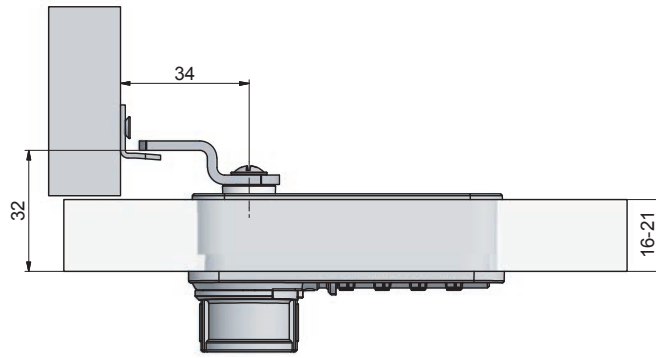

Dial Lock 57.01 Fix



Lock for Cam

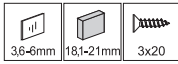
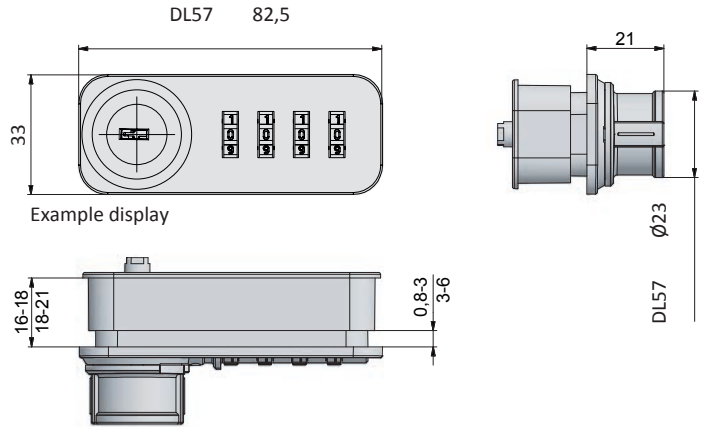

Dial Lock				Finish
57	140.410	140.412	140.411	black

X = 1 - 5 available systems

System components Systembauteile



Cam 477

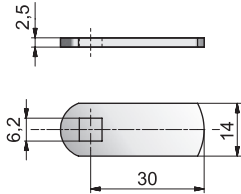

Cam 460

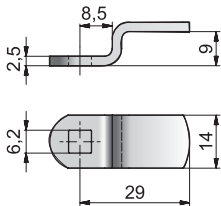

SKU	Finish
140.413	nickel plated

SKU	Finish
140.414	nickel plated