



QUICK Ø35



WORKTOP
CONNECTORS





SYMBOLS AND FINISHES LEGEND

SYMBOLS

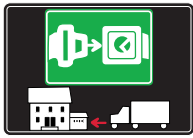

= SHELF SAFELY LOCKED DURING TRANSPORTATION AND AT HOME



= ANTI-TURNOVER LOCKING SYSTEM



= NORMS / PATENTS



= PHILLIPS / POZIDRV



= WITH BUFFER



= PART NO.



= BLADE SLOT



= WITH MAGNET



= PCS. PER PACKAGE



= COMBI SLOT



= HEXAGONAL SOCKET



= NEWTON



= CAPACITY LOADING



= HEXALOBULAR SOCKET



= FRICTION



= WOOD / GLASS THICKNESS



= COUNTERSUNK HEAD



= AUTOMATIC



= HOLE DIAMETER



= PAN HEAD



= DROP DOWN



= DIAMETER



= FLANGE HEAD



= LENGTH



= FLAT HEAD



= STANDARD HINGE



= HEIGHT



= TRILOBULAR SCREW



= KIMANA HINGE



= RIGHT VERSION



= SELF-TAPPING SCREW



= FLAP HINGE



= LEFT VERSION



= EURO THREAD



= WITH SPRING



= SETTING CODE



= METRIC THREAD



= WITHOUT SPRING



= PCS. PER PAD



= PRE-INSERTED SCREW



= REVERSED SPRING



= CUT ON REQUEST



= PRE-INSERTED SCREW AND SPREADING BUSH























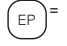

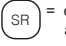
= SELF ADHESIVE



= WITH FLANGE

NOTE: Printing errors and omissions may exist despite our best efforts to ensure accuracy. We reserve the right to alter specifications without notice.

MATERIALS

| | | | | |
|--|---|---|---|---|
|  ZA = Zinc Alloy |  ST = Steel |  HSS = High Speed Steel |  BR = Brass |  ABS = Acrylonitrile Butadiene Styrene |
|  ZAnk = Nickel-plated Zinc Alloy |  STzk = Zinc-plated Steel |  AL = Aluminium |  WD = Wood |  EVA = Ethylene Vinyl Acetate |
|  EP = ENGINEERING PLASTIC | | +  EP = other engineering plastic available on request | |  SR = SOFT RUBBER |
| | | | | +  SR = other soft rubber available on request |
|  EPn = Natural Engineering Plastic |  EPc = Clear Engineering Plastic |  SRn = Natural Soft Rubber | | |
|  EPw = White Engineering Plastic |  EPg = Grey Engineering Plastic |  SRw = White Soft Rubber | | |
|  EPwg = Water Green Engineering Plastic |  EPa = Anthracite Engineering Plastic |  SRb = Black Soft Rubber | | |



FINISHES



= OTHER FINISHES AVAILABLE ON REQUEST

| PART NO. | FINISHES | PART NO. | FINISHES | PART NO. | FINISHES |
|----------|----------------------|----------|--------------------------|----------|------------------------------|
| 00 | Insignificant finish | IF | Middle Grey | RO | Red |
| AA | Natural | IJ | Light Grey | UT | T-Met 9007 |
| AB | White | IL | Grey 20 | UZ | T-Met |
| AE | White 9010 | IN | Grey met. 26 | WA | Bronzed |
| EA | Black | JB | Bright Aluminium | WI | Burnished |
| EC | Matt Black | JC | Aluminium - Chrome | XD | Satin-finished Steel |
| EE | Anthracite | JD | Matt Aluminium | YA | Nickel-plated |
| EW | Grey 9007 | JE | Satin-finished Aluminium | YB | Bright Nickel-plated |
| FU | Gunmetal | JF | Aluminium - Brass | YC | Matt Nickel-plated |
| FV | Gunmetal V52 | JG | Aluminium 5 | YD | Satin-finished Nickel-plated |
| GR | Raw | JL | Aluminium PE 11 | YQ | Black Nickel |
| HA | Brass-Plated | JM | Aluminium RAL 9006 | Z9 | Black Zinc |
| HH | Tropicalized | KA | Chrome | ZA | Zinc alloy |
| HL | Raw Brass | KB | Bright Chrome | ZN | Zinc-plated |
| HX | Graphite | KC | Matt Chrome | ZQ | Bright Gold |
| IA | Grey | LD | Brown 8019 | ZY | Titanium |
| IB | Metallic Grey | NN | Metallic Beige | ZZ | Clear |

QUICK

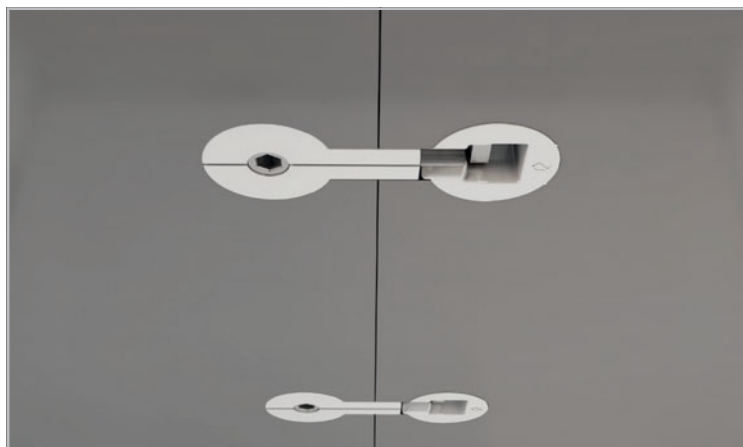

QUICK Ø35 has been conceived to join two worktops or panels together.

It consists of two parts:

- main body with tightening dowel M8x64, M8x100 or M8x150;
- round cap to suit the dowel head.

The installation is fast and simple as the two parts don't fall when placed in position.

The fastening becomes easier by using an S6 mm allen wrench, or even better, a cordless driver.

It is suitable for worktops and panels minimum 25 mm thick.

The tightening is 6 mm.

25 mm min.

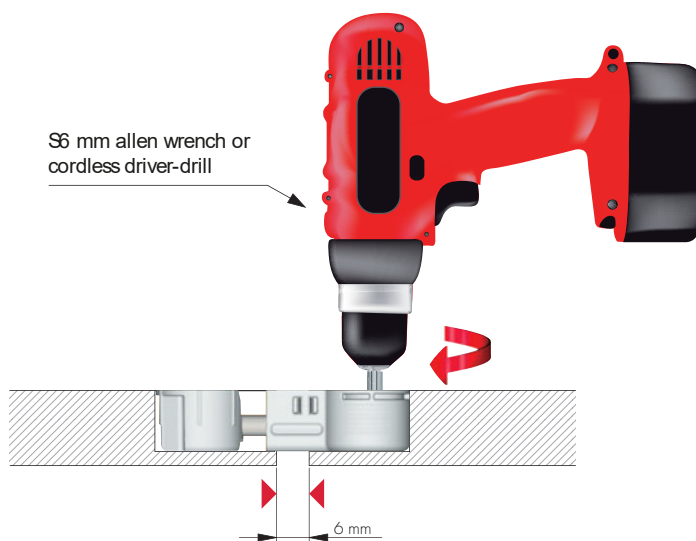
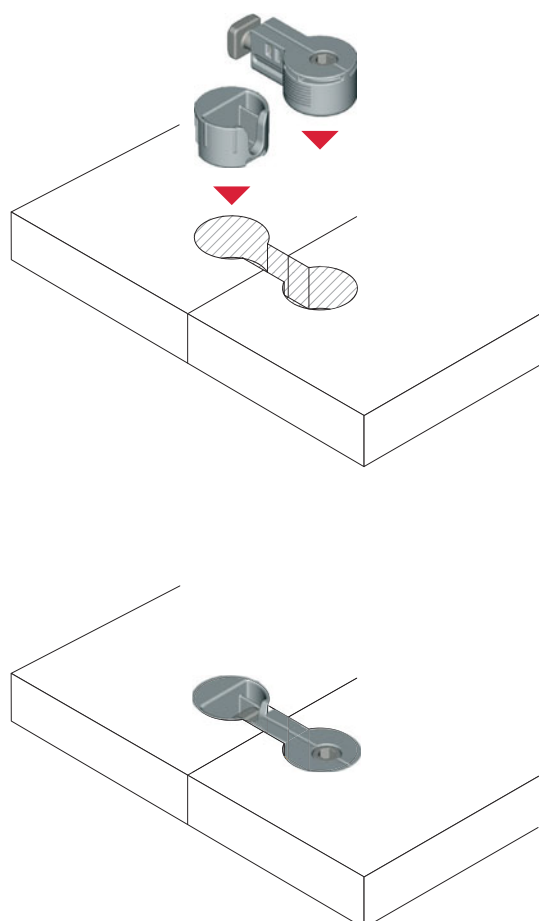

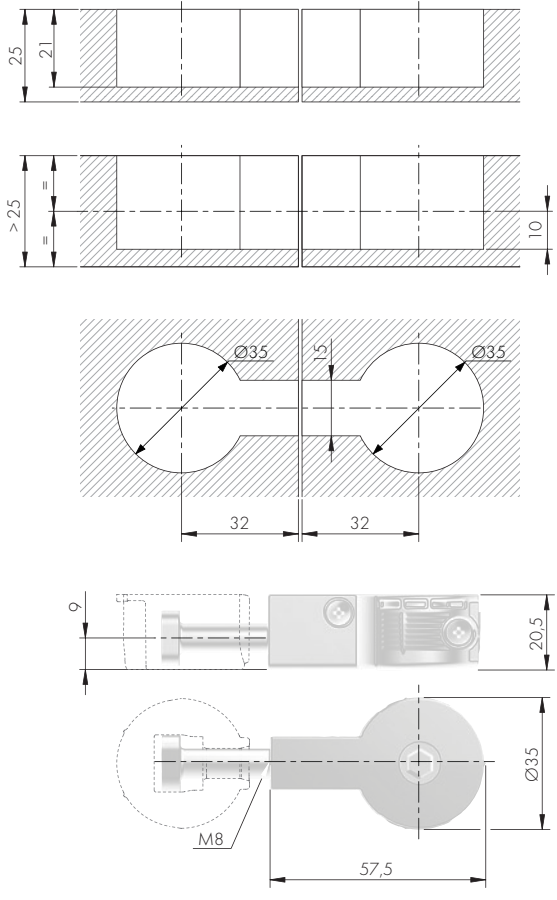

| | | | |
|--|------------|--|------------|
| | = Ø 35 mm | | = S6 |
| | ZA | | ST |
| | EP | | = 250 pcs. |
| | 2162101000 | | |

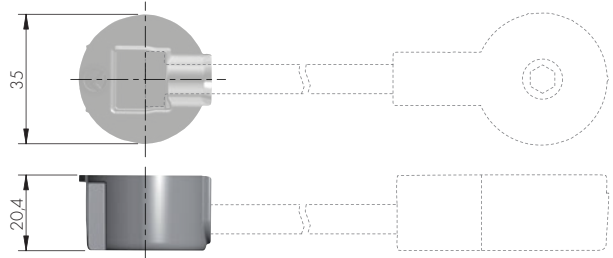

| | | | |
|--|------------|--|------------|
| | = Ø 35 mm | | |
| | EP | | = 500 pcs. |
| | 2162001000 | | |