



Starter Kit - Small

Important Information

Striplox locking tabs (removable if required)



Remove tabs carefully with a small blade or screwdriver to enable multiple assemblies/dis assemblies. If you want permanent fixing, simply leave locking tab in place.

Your Striplox Starter Kit contains:
Includes Handy Carry Case – “Perfect to Refill”

Striplox Pro 55	4
Striplox Pro 23	4
Striplox Clip 50	4
Striplox 90D 98mm White	4
Striplox Mini 60mm	4
Striplox Mini 120mm	4
Striplox Mega-Lox 241mm-9.5"3/8"	4
Striplox 180D 114mm 4" BLK	2
Striplox Griplox No.20 Biscuits	10
ACCESSORIES	
Striplox pro 55 jig (set) Red	1
Striplox clip50 jig (set) Red	1
Striplox pro 23 jig (set) Red	1
Mark out Template (see over)	1

Av. Independencia Ote.1323 Col. Independencia . Toluca, México. MÉXICO
C.P.50070 Tel. (722) 215-51-68 www.cymisa.com.mx

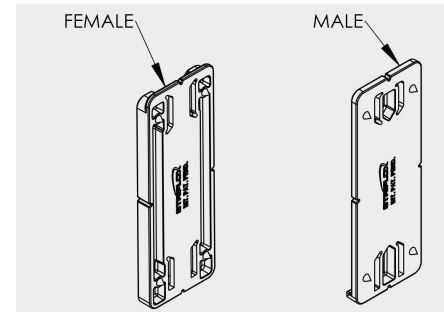

Material	Grivory GV
Colour	Red
Fixing Method	Slide to fit

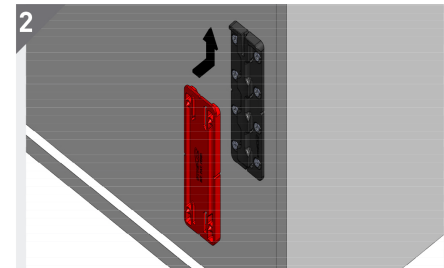

Attach the Striplox Pro 55 Jig onto the Striplox Pro 55 part by sliding into its fully locked position.

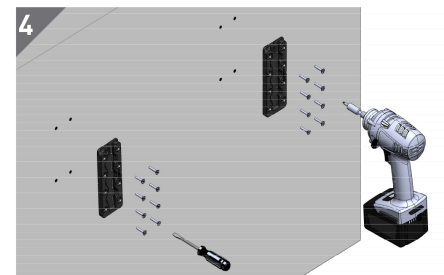

Fix the Striplox Pro 55 part into position using the indented markings using sufficient screws for satisfactory embedment. (note: dry wall mountings may need to be used)

Installation Guide Pro 55 Jig

To be used in conjunction with the Striplox Pro 55 installation guide.

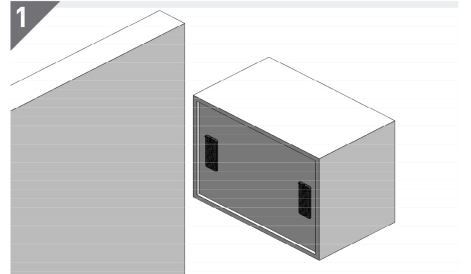

Attach male Striplox Pro 55 onto the object following Striplox Pro 55 installation guide. Use the female Striplox Pro 55 part on the wall.

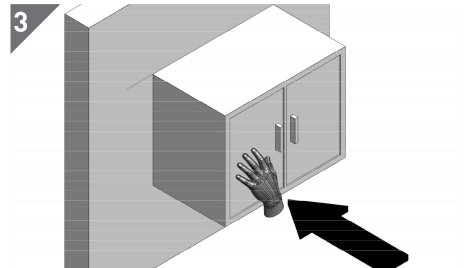

Position object and push against the wall firmly. The jig will indent the corner screw positions for the opposing Striplox Pro 55 part.

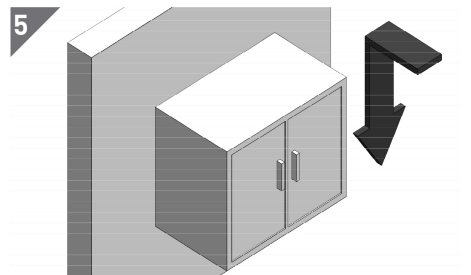

Place the object onto the wall push and slide into position ensuring the parts have interlocked.

Striplox™ use is subject to variable material and conditions. Technical information and load capacities are a guide only without warranty

Striplox™ and Joinlox® are trademark and patent protected internationally. - Installation Guide Pro 55 Jig

