

LEVELLER WITH HEXAGONAL GLIDE

- Suitable to align heavy duty wardrobes, bookcases and modular furniture as well as side desks.
- To be installed onto the bottom edge of the carcass side or onto the bottom panel according to construction unit.
- Adjustment to be carried out from underneath by using an open-ended wrench key 13 mm.
- Sleeve and foot in steel provided with hexagonal plastic glide.
- Adjustment: 9-25 mm.

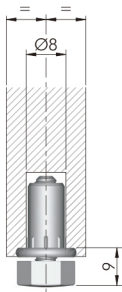

INSTALLATION

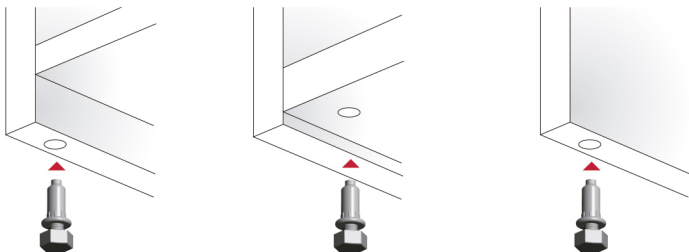

ADJUSTMENT

